

SINGLE SPHERE FLEXIBLE CONNECTOR

Flexible connectors are used to absorb thermal and seismic movement, absorb hydraulic shock, provide vibration and noise dampening, ease installation and correct minor misalignment of piping and components. They come in a variety of sizes, materials, and connection ends for numerous applications.

Similar to the metal flexible connectors in application advantages, single sphere flexible connectors are suitable for pressure and vacuum services. The spherical shape is stronger than cylindrical elastomer connectors and disperses pressure evenly over a larger surface area. The streamline shape also reduces turbulence and sediment build-up and lessens deformation while under pressure. The elastomer allows greater movements in the axial, elongation, lateral, and angular directions and provides a wide service range due to its chemical resistance characteristics.



Pressure / Temperature*

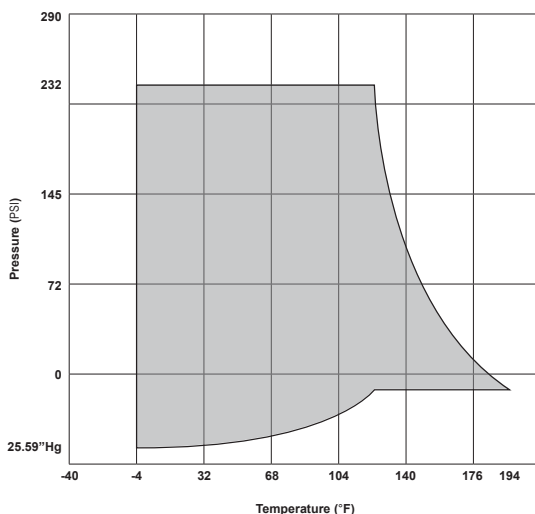

Ratings

Max. Working Pressure	232 PSI
Test Pressure	348 PSI
Burst Pressure @ 80°F	850 PSI
Vacuum Rating	25.59\"Hg (650 Torr)
Operating Temperature	-4°F to 194°F

Part Numbers & Weight

Size	Part Number	Approx. Wt (Lbs)
2-1/2	FNW40L	14.74
3	FNW40M	16.50
4	FNW40P	18.26
5	FNW40S	23.98
6	FNW40U	31.68
8	FNW40x	42.24
10	FNW4010	55.00

* Figure 40 should not be used at the maximum working pressure and working temperature at the same time.

SINGLE SPHERE FLEXIBLE CONNECTOR

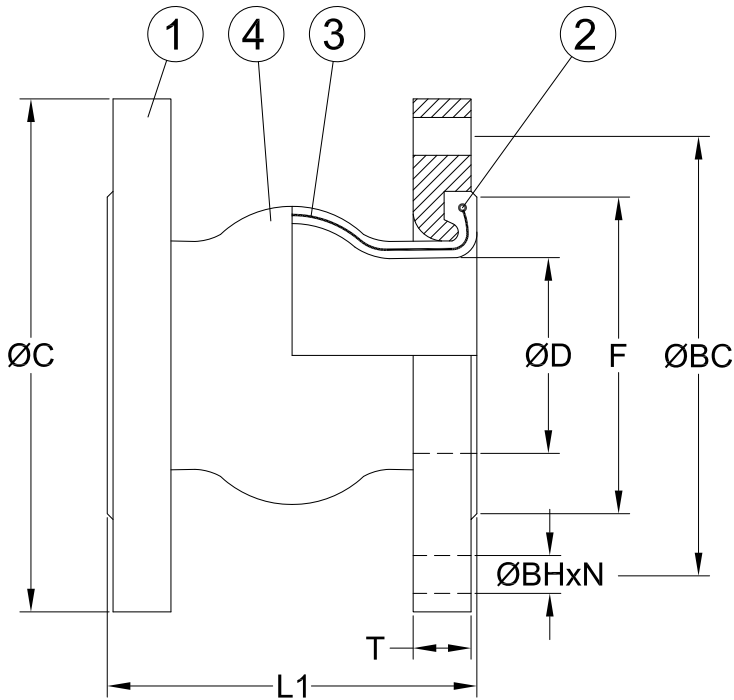

Dimensions (inches)

Size	ØC	ØD	F	L1	ØBC	ØBH	N	T
2-1/2	7.0	2.68	4.17	6.0	5.50	0.75	4	0.71
3	7.5	2.99	4.57	6.0	6.00	0.75	4	0.71
4	9.0	4.06	5.91	6.0	7.50	0.75	8	0.71
5	10.0	5.04	7.09	6.0	8.50	0.87	8	0.79
6	11.0	5.98	8.23	6.0	9.50	0.87	8	.87
8	13.5	7.64	10.24	6.0	11.75	0.87	8	.87
10	16.0	9.84	12.60	8.0	14.25	1.00	12	.94

Braid Limits

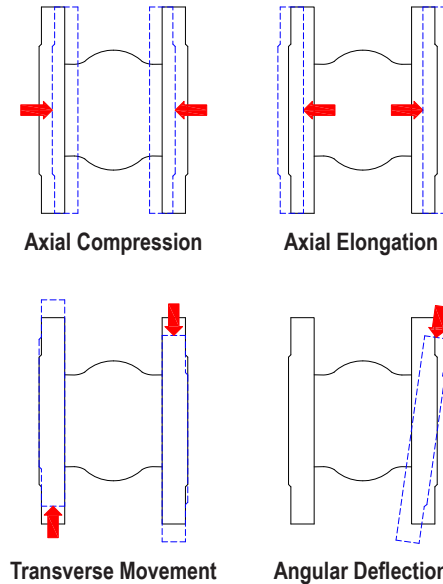

Size	Maximum Axial Compression	Maximum Axial Elongation	Maximum Transverse Movement	Maximum Angular Deflection
2-1/2	0.500"	0.375"	0.50"	15°
3	0.500"	0.375"	0.50"	15°
4	0.625"	0.375"	0.50"	15°
5	0.625"	0.375"	0.50"	15°
6	0.625"	0.375"	0.50"	15°
8	0.625"	0.375"	0.50"	15°
10	0.625"	0.500"	0.75"	15°

Standard Materials

Ref. No.	Description	Material
1	Flange	Carbon Steel
2	Reinforcement Wire	Carbon Steel
3	Reinforcement Fabric	Synthetic Fiber
4	Elastomer Sleeve	EPDM

DOC: FNW4005 Ver. 3/2012

© 2012 - FNW. All rights reserved.

The FNW logo is a trademark of Ferguson Enterprises, Inc., PL Sourcing, PO Box 2778, Newport News, VA 23609

The contents of this publication are presented for information purposes only, and while effort has been made to ensure their accuracy, they are not to be construed as warranties or guarantees, expressed or implied, regarding the products or services described herein or their use or applicability. All sales are governed by our terms and conditions, which are available on request. We reserve the right to modify or improve the designs or specifications of our products at any time without notice. Always verify that you have the most recent product specifications or other documentation prior to the installation of these products.